

Township 16 South, Range 67 East Northeast Quarter

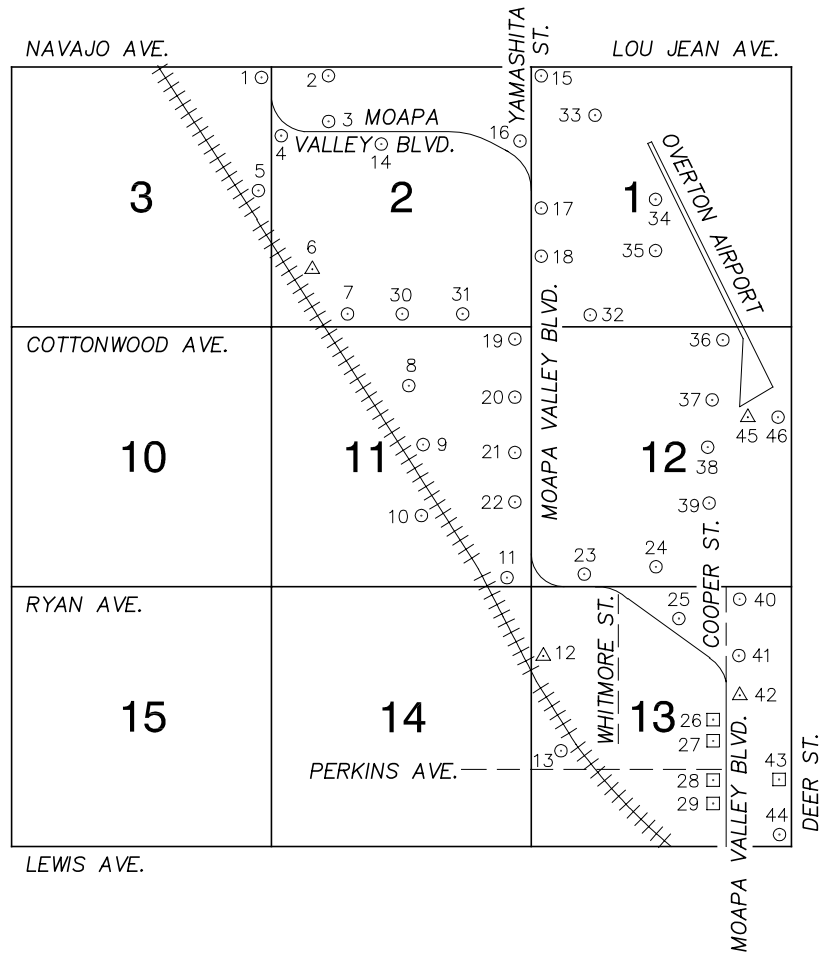

NORTH AMERICAN VERTICAL
DATUM OF 1988
- ALL ELEVATIONS IN METERS -

No.	STATION	ELEVATION (METERS)	SET	DESCRIPTION
1	OC67 3NES 2000	408.630	SET	RIVET AND ROUND ALUMINUM PLATE IN A CONCRETE MONUMENT, SOUTHWEST CORNER OF NAVAJO AVE. AND MOAPA VALLEY BLVD. NEAR A WOOD LIGHT POLE.
2	OC67 2NNW6 2000	406.255	SET	RIVET AND ROUND ALUMINUM PLATE IN TOP OF CURB, WEST SIDE OF PINWHEEL ST. 12' SOUTH OF END OF CURB.
3	OC67 2NW6 2000	404.756	SET	RIVET AND ROUND ALUMINUM PLATE IN TOP OF CURB, WEST SIDE OF PINWHEEL ST. 90' NORTH OF MOAPA VALLEY BLVD.
4	OC67 2NWW6 2000	406.499	SET	RIVET AND ROUND ALUMINUM PLATE IN A CONCRETE MONUMENT, 32' EAST OF THE EAST E.O. OF LYMAN ST. NEAR THE PROJECTED EAST - WEST ALIGNMENT OF MOAPA VALLEY BLVD.
5	OC67 3E4 2000	404.938	SET	RIVET AND ROUND ALUMINUM PLATE IN A CONCRETE MONUMENT, 35' WEST OF THE WEST E.O. AT THE ANGLE POINT. OF SWAPP DR. AND LYMAN ST., 2' SOUTH OF POWER POLE (NO NUMBER)
6	N 165 1935	401.975	FIND	USC&GS BRASS CAP IN A CONCRETE MONUMENT, WEST SIDE OF SWAPP DR. ACROSS FROM 1420 SWAPP DR., 47.3' EAST OF THE EAST RAIL, 6' SOUTHEAST OF A POWER POLE, 10' WEST OF THE WEST E.O. OF SWAPP DR.
7	OC67 2SSW6 2000	401.171	SET	RIVET AND ROUND ALUMINUM PLATE IN A CONCRETE MONUMENT, NORTHEAST CORNER OF SWAPP DR. AND COTTONWOOD AVE. NEAR A POWER POLE. (NO NUMBER)
8	OC67 11N6 2000	399.888	SET	RIVET AND ROUND ALUMINUM PLATE IN A CONCRETE MONUMENT, 3' WEST OF THE WEST E.O. OF HEYER ST. NEAR THE PROJECTED CENTERLINE ALIGNMENT OF ANITA AVE.
9	OC67 11C4 2000	400.030	SET	RIVET AND ROUND ALUMINUM PLATE IN A CONCRETE ELEC. TRANSFORMER PAD, 10' EAST OF THE EAST E.O. 1000' SOUTH OF ANITA AVE. AT THE PT OF THE CURVE OF HEYER ST.
10	OC67 11SE6 2000	398.019	SET	RIVET AND ROUND ALUMINUM PLATE IN A CONCRETE MONUMENT, 50' WEST OF RAILROAD TRACKS, 60' SOUTHWEST OF THE PI OF BRYNAR AVE. AND THE RAILROAD TRACKS. NEAR A POWER POLE. # (LW17)
11	OC67 11SES 2000	393.674	SET	RIVET AND ROUND ALUMINUM PLATE IN A CONCRETE MONUMENT, 50' EAST OF RYAN AVE. AND RAILROAD TRACKS NEAR THE SOUTHWEST CORNER OF A 6' CHAIN LINK FENCE.

CLARK COUNTY VERTICAL CONTROL v.2003

CLARK COUNTY SURVEYOR'S OFFICE
5051 SOUTH PARADISE ROAD
LAS VEGAS, NEVADA 89119
(702) 455-0640

CONVERSION FACTOR:

METERS X $\left(\frac{3937}{1200}\right)$ = U.S. SURVEY FEET

REVISED
08/01/2003

SHEET
1 OF 3

16-67
NE

No.	STATION	ELEVATION (METERS)	DESCRIPTION	No.	STATION	ELEVATION (METERS)	DESCRIPTION
12	J 165 1935	391.225	F USC&GS BRASS CAP, STAMPED J165 1935, (1' SUBSURFACE) 50' EAST OF THE RAILROAD TRACKS, AND 220' NORTH OF INGRAM AVE., UNDER A BARB WIRE FENCE 2.2' NORTH OF CONCRETE MARKER POST.	25	0C67 13N6 2000	386.624	S RIVET AND ROUND ALUMINUM PLATE IN TOP OF CURB, EAST SIDE OF MOAPA VALLEY BLVD. AND 90' SOUTHEAST OF THE PI OF MOAPA VALLEY BLVD. AND ANDERSEN ST. ± 25' FROM THE END OF CURB AND GUTTER.
13	0C67 13SW6 2000	392.996	S RIVET AND ROUND ALUMINUM PLATE IN A CONCRETE MONUMENT, 25' WEST OF THE RAILROAD TRACKS AND 270' NORTH OF PERKINS AVE. NEAR THE SOUTHEAST CORNER OF THE OLD RAILROAD DEPOT CONCRETE PAD.	26	3C67 13E6	385.579	F 2" BRASS CAP, STAMPED "CCED MV 21", IN TOP OF CURB, SOUTHWEST PC OF MOAPA VALLEY BLVD. AND THOMAS AVE.
14	0C67 2N6 2000	403.871	S RIVET AND ROUND ALUMINUM PLATE IN A CONCRETE RETAINING WALL, 32' SOUTH OF THE SOUTH EAST E.O. OF MOAPA VALLEY BLVD. 1025' EAST OF PINWHEEL ST. IN FRONT OF 1897 MOAPA VALLEY BLVD.	27	3C67 13E6A	386.330	F 2" BRASS CAP, STAMPED "CCED MV22", IN TOP OF CURB, SOUTHWEST PC OF MOAPA VALLEY BLVD. AND VIRGINIA AVE.
15	0C67 1NWS 2000	408.461	S RIVET AND ROUND ALUMINUM PLATE IN A CONCRETE MONUMENT, 12' EAST OF EAST E.O. OF YAMASHITA ST. 830' SOUTH OF RON AVE. 2' WEST OF GUARD RAIL END.	28	3C67 13SE6	387.026	F 2" BRASS CAP, STAMPED "CCED MV23", IN TOP OF CURB, SOUTHWEST PC OF MOAPA VALLEY BLVD. AND PERKINS AVE. NEAR THE PC OF MOAPA VALLEY BLVD.
16	0C67 2NEE6 2000	403.185	S RIVET AND ROUND ALUMINUM PLATE IN THE SOUTH END OF A WING WALL OF YAMASHITA BRIDGE, SOUTHEAST CORNER OF MOAPA VALLEY BLVD. AND YAMASHITA BRIDGE.	29	3C67 13SE6A	386.459	F 2" BRASS CAP, STAMPED "CCED MV24", IN TOP OF CURB, SOUTHWEST PC OF MOAPA VALLEY BLVD. AND ALMA AVE. NEAR THE PC OF MOAPA VALLEY BLVD.
17	0C67 1W4 2000	400.119	S RIVET AND ROUND ALUMINUM PLATE IN A CONCRETE ELEC. TRANSFORMER PAD, EAST SIDE OF MOAPA VALLEY BLVD. 1500' SOUTH OF YAMASHITA ST. IN FRONT OF A RED BRICK HOUSE.	30	0C67 2S4 2000	399.949	S RIVET AND ROUND ALUMINUM PLATE IN A CONCRETE MONUMENT, NORTHEAST CORNER OF COTTONWOOD AVE. AND HEYER ST. NEAR PP # (Lg C9910)
18	0C67 1SWW6 2000	397.546	S RIVET AND ROUND ALUMINUM PLATE IN A CONCRETE HEADWALL, EAST SIDE OF MOAPA VALLEY BLVD. 350' NORTH OF SCOTT AVE. 15' NORTH OF FENCE CORNER.	31	0C67 2SSE6 2000	398.050	S RIVET AND ROUND ALUMINUM PLATE IN A CONCRETE MONUMENT, NORTHEAST CORNER OF COTTONWOOD AVE. AND ST. JOSEPH ST. NEAR PP # (Lg C996)
19	0C67 11NES 2000	396.453	S RIVET AND ROUND ALUMINUM PLATE IN A CONCRETE HEADWALL, SOUTHWEST CORNER OF MOAPA VALLEY BLVD. AT COTTONWOOD AVE.	32	0C67 1SSW6 2000	395.307	S RIVET AND ROUND ALUMINUM PLATE IN A CONCRETE MONUMENT, NORTH SIDE OF COTTONWOOD AVE. 1320' EAST OF MOAPA VALLEY BLVD. BETWEEN A DOUBLE SET OF WOODEN POWER POLES.
20	0C67 11NEE6 2000	394.830	S RIVET AND ROUND ALUMINUM PLATE IN A CONCRETE MONUMENT, NORTHWEST CORNER OF MOAPA VALLEY BLVD. AND ANITA AVE. NEAR PP # (Lg C105)	33	0C67 1NW6 2000	415.576	S RIVET AND ROUND ALUMINUM PLATE IN A CONCRETE MONUMENT, NORTHEAST CORNER OF AIRPORT RD. AND LOU ST. 25' EAST OF THE EAST E.O. OF AIRPORT RD.
21	0C67 11E4 2000	392.742	S RIVET AND ROUND ALUMINUM PLATE IN A CONCRETE WATER VAULT, WEST SIDE OF MOAPA VALLEY BLVD. 210' SOUTH OF CATHERINE AVE.	34	0C67 1C4 2000	413.304	S RIVET AND ROUND ALUMINUM PLATE IN A CONCRETE MONUMENT, WEST SIDE OF ANDERSON ST. 260' SOUTH OF AIRPORT RD. NEAR POWER POLE # (Lg 8173)
22	0C67 11SEE6 2000	392.055	S RIVET AND ROUND ALUMINUM PLATE IN TOP OF CURB, SOUTH SIDE OF ENTRANCE TO OVERTON POWER DISTRICT 5' NORTH OF A FIRE HYDRANT.	35	0C67 1S6 2000	412.061	S RIVET AND ROUND ALUMINUM PLATE IN A CONCRETE MONUMENT, SOUTHWEST CORNER OF AIRPORT RD. AND WILLOW AVE. 8' SOUTHWEST OF E.O.
23	0C67 12SSW6 2000	389.794	S RIVET AND ROUND ALUMINUM PLATE IN TOP OF CURB, NORTHEAST CORNER OF MOAPA VALLEY BLVD. AND LA POINTE ST.	CLARK COUNTY VERTICAL CONTROL v.2003			
24	0C67 12S4 2000	386.761	S RIVET AND ROUND ALUMINUM PLATE IN TOP OF CURB, NORTH SIDE OF RYAN AVE. 450' EAST OF LOU DR. 10' WEST OF THE END OF CURB AND GUTTER.	CLARK COUNTY SURVEYOR'S OFFICE 5051 SOUTH PARADISE ROAD LAS VEGAS, NEVADA 89119 (702) 455-0640			CONVERSION FACTOR: METERS X $\left(\frac{3937}{1200}\right)$ = U.S. SURVEY FEET
			REVISED 09/01/2006		SHEET 2 OF 3		16-67 NE

No.	STATION	ELEVATION (METERS)	DESCRIPTION	No.	STATION	ELEVATION (METERS)	DESCRIPTION
36	OC67 12NNE6 2000	411.242	SET RIVET AND ROUND ALUMINUM PLATE IN A CONCRETE MONUMENT, SOUTHWEST CORNER OF AIRPORT RD. AND COTTONWOOD AVE. 25' WEST OF THE WEST E.O.	48			
37	OC67 12NE6 2000	404.640	SET RIVET AND ROUND ALUMINUM PLATE IN A CONCRETE MONUMENT, NORTHEAST CORNER OF COOPER ST. AND LEE AVE. NEAR A WATER VAULT.	49			
38	OC67 12E6 2000	387.813	SET RIVET AND ROUND ALUMINUM PLATE IN A CONCRETE HEADWALL OF AN INLET FOR THE MUDDY RIVER CROSSING AT COOPER ST. (875 COOPER ST.)	50			
39	OC67 12SE6 2000	389.334	SET RIVET AND ROUND ALUMINUM PLATE IN A CONCRETE MONUMENT, EAST SIDE OF COOPER ST. 500' NORTH OF WAGONMASTER AVE. NEAR A POWER POLE., ACROSS FROM 725 WAGONMASTER AVE.	51			
40	OC67 13NNE6 2000	387.259	SET RIVET AND ROUND ALUMINUM PLATE IN A CONCRETE MONUMENT, EAST SIDE OF COOPER ST. 320' NORTH OF LESTER AVE. NEAR A POWER POLE.	52			
41	OC67 13NE6 2000	385.518	SET RIVET AND ROUND ALUMINUM PLATE IN A CONCRETE MONUMENT, NORTHEAST CORNER OF COOPER ST. AND ROBISON AVE. 2' EAST OF POWER POLE.	53			
42	F 315 1949	385.322	FOUND USC&GS BRASS CAP, STAMPED "F 315 1949", SET VERTICALLY IN THE FACE OF THE NORTHWEST PORTION OF THE WALL OF A CHURCH LOCATED ON THE EAST SIDE OF MOAPA VALLEY BLVD. 200' SOUTH OF BONELLI AVE.	54			
43	OC67 13SEE6 2000	383.191	SET RIVET AND ROUND ALUMINUM PLATE IN A CONCRETE MONUMENT, SOUTHWEST CORNER OF DEER ST. AND ROBIN AVE.	55			
44	OC67 13SES 2000	382.607	SET RIVET AND ROUND ALUMINUM PLATE IN THE SOUTHWEST CORNER OF A CONCRETE DRAINAGE SWALE, NORTH SIDE OF LEWIS AVE. 145' WEST OF DEER ST.	56			
45	A 165 1935	408.857	FOUND USC&GS BRASS CAP, STAMPED "A165 1935", LOCATED INSIDE THE OVERTON CEMETERY, 100' EAST OF THE WEST CHAIN LINK FENCE AND 250' SOUTH OF THE NORTH CHAIN LINK FENCE, 56' NORTH OF THE NORTHWEST CORNER OF A STEEL FENCE AROUND THE ANDERSON BURIAL PLOT.	57			
				58			
46	OC67 12NEE6 2000	409.674	SET RIVET AND ROUND ALUMINUM PLATE IN A CONCRETE FOOTING OF THE ANGLE POINT IN THE AIRPORT BARBED WIRE FENCE, NORTH SIDE OF MORMON MESA RD. AND 160' WEST OF DEER ST.	CLARK COUNTY VERTICAL CONTROL v.2003			
47				CLARK COUNTY SURVEYOR'S OFFICE 5051 SOUTH PARADISE ROAD LAS VEGAS, NEVADA 89119 (702) 455-0640		CONVERSION FACTOR: METERS X $\left(\frac{3937}{1200}\right)$ = U.S. SURVEY FEET	
				REVISED 08/01/2003	SHEET 3 OF 3	16-67 NE	